

**Final Year Project Report**  
**District & Session's Court Nankana Sahib**



**Project Advisor:**  
**Dr. Muhammad Yousaf Awan**  
**Dr. Saima Gulzar**  
**Ar. Mehmoona Rashid**  
**Ar. Najam Ul Haq**

**Submitted By:**  
**Sayydea Maria Saeed – 13004101039**

**Session**  
**(2013-2018)**  
**BS Architecture – Batch 4**

**University of Management and Technology**  
**C-II Johar Town Lahore Pakistan**

## **Abstract**

Court is an institution that the government sets up to settle disputes through a legal process. Courts are important because they help protect our Constitutional rights to equal protection and due process under the law. Both criminal and civil courts provide the opportunity for the parties to have their cases heard by neutral judges and/or juries. The judicial complex and its architecture has a representative role in a country's justice system. The system has to be just, efficient and secure with minimum complication and maximum output. The idea is to design a district court that enable the system to work swiftly and provide justice to society and maximum security for both the public and the professionals practicing law in the courts. Moreover, provision of appropriate facilities and space, considering the special function of courts and provision of technology throughout the court and converting paper work of court to technology-based environment. The users of different kinds and nature will use the complex. Therefore, the complex has to care for all the different kinds of users. The project will be located in Nankana Sahib City in order to improve the infrastructure and provide the facilities which complete the requirements of the court. The project must express stability, integrity and rigor of judicial process in the district.

# CONTENTS

---

<b>CONTENTS</b> .....	<b>1</b>
LIST OF FIGURES .....	4
LIST OF TABLES .....	5
<b>1. INTRODUCTION</b> .....	<b>6</b>
1.1 PROJECT TITTLE.....	6
1.2 INTRODUCTION.....	6
1.3 BACKGROUND STUDY.....	6
1.4 PROJECT DESCRIPTION .....	7
1.5 SITE .....	7
1.6 FEASIBILITY.....	7
1.7 AIMS AND OBJECTIVES .....	8
1.8 METHODOLOGY.....	8
1.9 SCOPE OF WORK.....	9
1.10 EXISTING COURT ISSUES .....	9
1.11 PHYSICAL OUTCOME OF THE PROJECT .....	9
1.12 NEED OF NEW DISTRICT COURT.....	10
<b>2. CONCEPT DEVELOPMENT OF DISTRICT &amp; SESSION COURT</b> .....	<b>12</b>
2.1 LITERATURE REVIEW .....	12
2.1.1 INTRODUCTION .....	12
Court:.....	12
Judiciary of Pakistan: .....	12
2.2 STRUCTURE OF COURTS IN PAKISTAN .....	13
JUDICIARY SYSTEM OF PAKISTAN .....	13
2.3 HIERARCHY OF COURTS IN PAKISTAN .....	13
2.4 FUNCTION OF COURTS .....	13
2.5 PROJECT EXPLANATION .....	13
2.5.1 District and Session courts of Pakistan.....	13
2.6 HIERARCHY OF COURTS .....	15
2.7 HIERARCHY OF DISTRICT AND SESSION COURT JUDGES .....	16
2.8 STRENGTH OF JUDGES.....	17
2.9 STUDY OF PERSONALS AND SPACES .....	17
2.9.1 District And Session Judge:.....	17
2.9.2 Additional Session Judge.....	17
2.9.3 Magistrate .....	17
2.9.4 Civil judge .....	17
2.9.5 Court room.....	18
2.9.6 Ahlmad .....	18
2.9.7 Reader.....	18
2.9.8 Nazir .....	18
2.9.9 Steno .....	18
2.9.10 Bakhshi khana .....	18
2.9.11 Administration branch.....	18
2.9.12 Naib court.....	18
2.9.13 Judicial record room.....	19
2.9.14 Copying branch .....	19
2.9.15 Stationary branch.....	19
2.9.16 Lock up.....	19
2.9.17 Lawyer’s chambers.....	19

2.9.18	Canteen.....	19
2.9.19	First aid.....	19
2.9.20	Bar room.....	20
2.9.21	Anti-room.....	20
2.9.22	Library.....	20
<b>3.</b>	<b>SITE ANALYSIS.....</b>	<b>21</b>
3.1	NANKANA SAHIB CITY.....	21
3.2	SITE LOCATION.....	21
3.3	SURROUNDINGS.....	22
3.4	LAND ANALYSIS.....	23
3.5	INFRA STRUCTURE.....	23
3.6	CLIMATE.....	23
3.7	REASON FOR THE SITE SELECTION/FEASIBILITY.....	25
3.7.1	SITE PICTURES.....	25
<b>4.</b>	<b>CASE STUDIES.....</b>	<b>27</b>
4.1	NATIONAL CASE STUDIES.....	27
4.1.1	INTRODUCTION.....	27
4.1.2	LOCATION.....	28
4.1.3	TYPE.....	28
4.1.4	AREA.....	28
4.1.5	FLOORS.....	28
4.1.6	TIMMINGS.....	28
4.1.7	GATES.....	28
4.1.8	LOCATION MAPS.....	28
4.1.9	FLOOR PLAN.....	29
4.1.10	BUILDINGS.....	29
4.1.11	FACILITIES.....	30
4.1.12	DESCRIPTION.....	30
4.1.13	STRUCTURE OF COURT ROOM.....	31
4.1.14	LAWYERS SITTING SPACE.....	32
4.1.15	CORRIDORS.....	33
4.1.16	PUBLIC WAITING AREA.....	34
4.1.17	CHAMBERS FOR LAWYERS.....	34
4.1.18	BAR HALL FOR LAWYERS.....	35
4.1.19	JUDGES CAR PARKING.....	36
4.1.20	LIBRARY, COMPUTER LAB AND NEWSPAPER AREA.....	36
4.1.21	MOSQUE.....	37
4.1.22	Building Material.....	38
4.1.23	Architecture.....	38
4.1.24	CONCLUSION.....	38
4.2	INTERNATIONAL CASESTUDY.....	39
4.2.1	INTRODUCTION.....	39
4.2.2	PROJECT DISCRPTION.....	40
4.2.3	MASTER PLAN.....	41
4.2.4	STUDY OF PERSONAL AND SPACES.....	41
4.2.5	FLOOR PALNS.....	42
4.2.6	COURT ROOM LAYOUT.....	43
	DETAIL OF FLOORS.....	44
4.2.7	ELEVATIONS/3D VIEWS.....	47
4.2.8	3D VIWES.....	48

4.2.9	CONCLUSION .....	49
<b>5.</b>	<b>REQUIREMENTS.....</b>	<b>50</b>
5.1	REQUIREMENTS .....	50
5.2	ANOTHER REQUIREMENTS .....	50
5.3	CALCULATIONS .....	51
<b>6.</b>	<b>BIBLIOGRAPHY .....</b>	<b>55</b>
6.1	BOOKS .....	55
6.2	JOURNALS .....	55
6.3	ARTICLES .....	55
6.4	RESEARCH PAPERS .....	55
6.5	OTHER REFERENCES .....	55

## List of Figures

Figure 1: Judiciary of Pakistan.....	12
Figure 2: Courts.....	14
Figure 3: District & Session Courts of Pakistan.....	14
Figure 4: Site Location.....	22
Figure 5: Surroundings.....	23
Figure 6: Climate.....	24
Figure 7: Site Pictures.....	26
Figure 8: Location Maps.....	28
Figure 9: Floor Plan.....	29
Figure 10: Court Room Structure.....	32
Figure 11: Lawyers Sitting Space.....	33
Figure 12: Corridors.....	33
Figure 13: Public Waiting Area.....	34
Figure 14: Chambers of Lawyers.....	35
Figure 15: Bar Hall for Lawyers.....	35
Figure 16: Hospital.....	36
Figure 17: ATM Machine.....	36
Figure 18: Judges Car Parking.....	36
Figure 19: Library, Computer Lab & Newspaper Area.....	37
Figure 20: Mosque.....	37
Figure 21: Project Description.....	40
Figure 22: Master Plan.....	41
Figure 23: Study of Personal Space.....	41
Figure 24: Floor Plans.....	42
Figure 25: Court Room Layout.....	43
Figure 26: Floors Details.....	46
Figure 27: Elevation 3D View.....	47
Figure 28: 3D View.....	48

## List of Tables

Table 1: Subordinate Courts .....	17
Table 2: Climate .....	24
Table 3: Judicial Court Complex.....	51
Table 4: Bar Association & Lawyers Chamber.....	52
Table 5: Judges Recreational Facilities .....	53
Table 6: Judicial Lockup's .....	53
Table 7: Allied Facilities 1 .....	54
Table 8: Allied Facilities 2 .....	54

# 1. INTRODUCTION

---

## 1.1 PROJECT TITLE

The title of the project is “DISTRICT AND SESSIONS COURT IN NANKANA SAHIB”

## 1.2 INTRODUCTION

District and session court is the basic need of every city for the peaceful environment and protect individual rights. As the population of NANKANA SAHIB grew, the facilities and need for the employers in district court also increase. Due to short area of courts and judicial colony Government of Punjab announced to shift all district & session courts to near big place.

- It is a live project.
- All the residency of judicial and district officer’s will be shift there. Plan for architecture is to construct 3 floor buildings for both residency colony and for District Court.
- According to my survey there is enough space for making lawyers offices. Some effects will impact on district. Area of city will grow. Wider place for parking and new peaceful structure for living purpose & society. More capacity for working people with a lot of jobs.

## 1.3 BACKGROUND STUDY

The existing judicial system of Pakistan has evolved over a long period of time. The legal history of Pakistan can conveniently be divided under four periods - Hindu era, Muslim period including the Mughal dynasty, British colonial period and post-independence period. The system has evolved through a process of reform and development, passing through four important stages of historical development, namely, Hindu Kingdom, Muslim Rule, British Colonial Rule and the partition of India. The personal laws of Hindus and Muslims as well as customary law have been developed in the first two stages, i.e. Hindu period and Muslim era, whereas other laws enforced in Pakistan, particularly procedural laws and organization/structure of the judicial system enacted in the third stage, namely, the British colonial period. In the fourth period, that is,

post-independence period, Pakistan continued to utilize the judicial system practiced in the British colonial period without any substantial change or major disruption, indeed making amendments/changes in the jurisdiction and procedural laws as per needs/requirements of the time.

## **1.4 PROJECT DESCRIPTION**

My thesis project is to design a District and Sessions Courts in Nankana sahib. The reason to choose this project is, as a residence of Nankana Sahib I felt that the need of new district and sessions court is most important issue these days. Due to converting of Nankana sahib in district level and increase of population, the area and facilities of district court are not fulfilling the requirements and needs.

- CLIENT:  
Punjab Government
- USERS:  
Govt. Of Punjab
- APPROX. AREA:  
28 Acres (224 Kanals)

## **1.5 SITE**

The site is located in Capital of Nankana Sahib District in the Punjab province of Pakistan. It is stated now 3.1 km far from Nankana on Shahkot road side by Shah Filling Station. The site is connected to the main road. The PSO shell is on the right side of the site which is the benefit for the Govt. 3 sessions are under the district Nankana sahib.

## **1.6 FEASIBILITY**

Nankana Sahib is a city and capital of Nankana Sahib District in the Punjab province of Pakistan. It is named after the first guru of the Sikhs, Guru Nanak. Guru Nanak spread the light of the universal message to this world so it is a city of high historic and religious value and is a popular pilgrimage site for Sikhs from all over the world. It is located about 80 kilometers south west of Lahore and about 75 kilometers east of Faisalabad. The area around Nankana Sahib was formerly a tehsil of Sheikhupura District. In May 2005, the provincial government decided to raise the status of Nankana Sahib to that of a district as a way of promoting development in the area. The development of Nankana Sahib, the birthplace of Guru Nanak in Pakistan is one of the

numerous projects by Punjab Government. City has a population of approximately 150,000. Due to the short area of the existing district court, it does not complete the requirements of the court. The new site required for district court is complete the requirements for construction the district and session court and residency.

## **1.7 AIMS AND OBJECTIVES**

- The judicial District Court needs to provide with all essential facilities like proper car parking, hygienic atmosphere and comfortable environment.
- Proper lawyer's chambers with attach toilets and common waiting area for public.
- Segregated parking for judges, lawyers and general public.
- Security of accused/prisoners.
- Integrating accessibility into all stages of courthouse design and planning.
- Complex and courtroom entrances, including automated devices that facilitate access through heavy doors.
- Access solutions to judges' benches that preserve the security and dignity afforded justices.
- Counters and other elements of public service areas.
- The complex must express stability, integrity and fairness of the Pakistan judicial process.

## **1.8 METHODOLOGY**

The surveys, their methodology and area assessments are worked out. The buildings like district court, civil court, session court and the other buildings are studied with respect to function and space standards and proposals are conducted. For this purpose and detailed research has been conducted to collect the data necessary for designing. All the results have been inferred through observation interview and discussions with the concerned persons. The data has been compiled in the form of this report and it form the basis of design concept of district complex.

## **1.9 SCOPE OF WORK**

- Provide the facilities and needs of requirements.
- Collection of information about project.
- Services
- Parking
- Landscaping
- Security
- Master planning
- Structure
- Comfortable environment

## **1.10 EXISTING COURT ISSUES**

- Short area of District court, all the buildings shifted to near place.
- No interconnection of buildings
- No proper space for parking
- No proper green area/ landscape
- No space for public sitting
- Poor condition of the chambers
- No proper accessibility

## **1.11 PHYSICAL OUTCOME OF THE PROJECT**

- Court room
- Conference room
- Almada record room
- Lawyer's chambers
- Case file building

- Head of the court building
- Printing and stationary shops
- Post office
- Cafeteria
- Bank
- Mosque
- Library
- Dispensary
- Lockups
- Bakhshi khana
- Parking
- Elevators
- Storage/kitchen
- Reception and general enquiries counter

## **1.12 NEED OF NEW DISTRICT COURT**

- Due to short area of courts and judicial colony Government of Punjab announced to shift all district & session courts to near big place.
- It is stated now 3.1 km far from Nankana on Shahkot road side by Shah Filling Station.
- Total bought area is 28 Acers.
- Total area of current district court 11.151 Acre.
- All the residency of judicial and district officer's will be shift there. Plan for architecture is to construct 3 floor buildings for both residency colony and for District Court.
- Due to increasing rate of cases and populations the present district court is insufficient and overcome the needs of court.



## 2. CONCEPT DEVELOPMENT OF DISTRICT & SESSION COURT

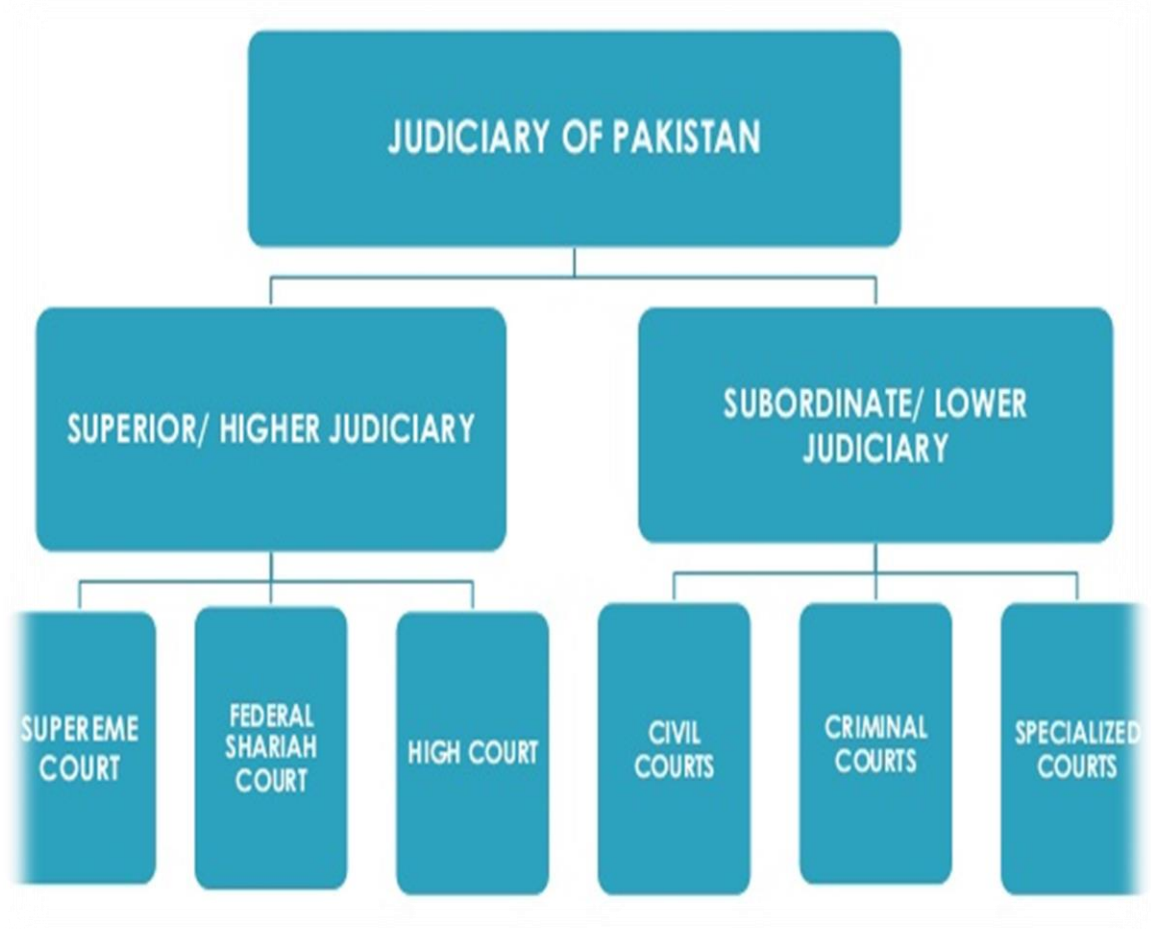
---

### 2.1 LITERATURE REVIEW

#### 2.1.1 INTRODUCTION

**Court:** is an institution that the government sets up to settle disputes through a legal process.

**Judiciary of Pakistan:** is a hierarchical system with two classes of courts: the superior (or higher) judiciary and the subordinate (or lower) judiciary.



**Figure 1: Judiciary of Pakistan**

## **2.2 STRUCTURE OF COURTS IN PAKISTAN**

**Judiciary system of Pakistan:** The system is made up of many Courts differing in levels of legal superiority and separated by jurisdiction. Some of the courts are Federal in nature while others are provincial.

## **2.3 HIERARCHY OF COURTS IN PAKISTAN**

1. Supreme Court of Pakistan
2. Federal Shariat court of Pakistan
3. High court
4. District and session court
5. Special Tribunals and Boards

## **2.4 FUNCTION OF COURTS**

The basic functions of courts have always been to maintain peace and order. It has various functions such as:

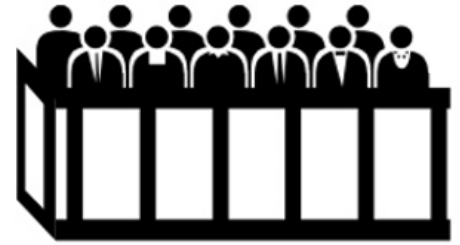
- To promote a peaceful environment.
- To reinforce the relations among people
- To protect family life
- To protect individual's rights
- To dissolve the problems of society

## **2.5 PROJECT EXPLANATION**

### **2.5.1 District and Session courts of Pakistan**

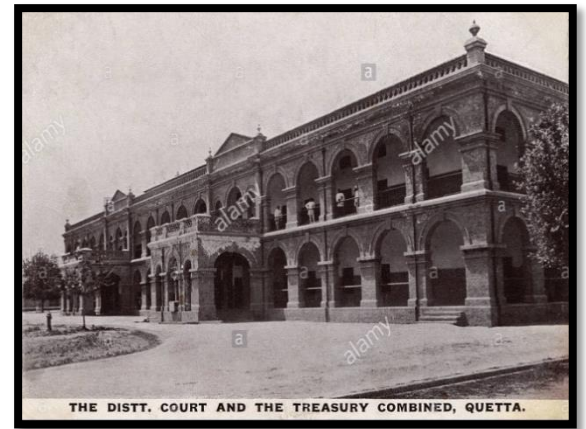
- District and session courts of Pakistan are operating at the district level.

- They are controlled by the high courts.
- District courts exist in every district of each province.
- Two types of cases:
  - Civil
  - Criminal



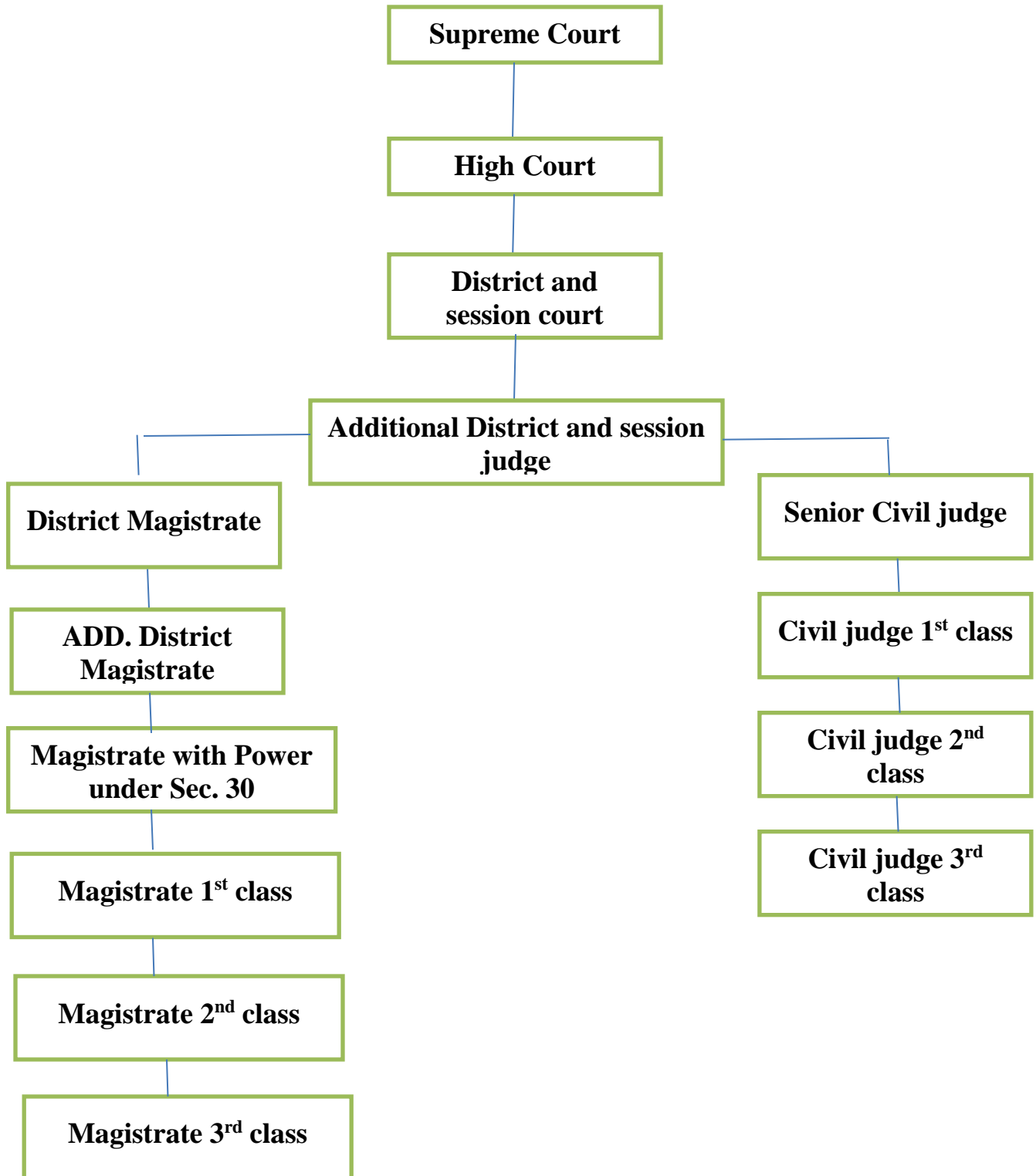
**Figure 2: Courts**

- In each District Headquarters, there are numerous Additional District & Session Judges who usually preside the courts.
- District & sessions Judge has executive and judicial power all over the district under his jurisdiction.

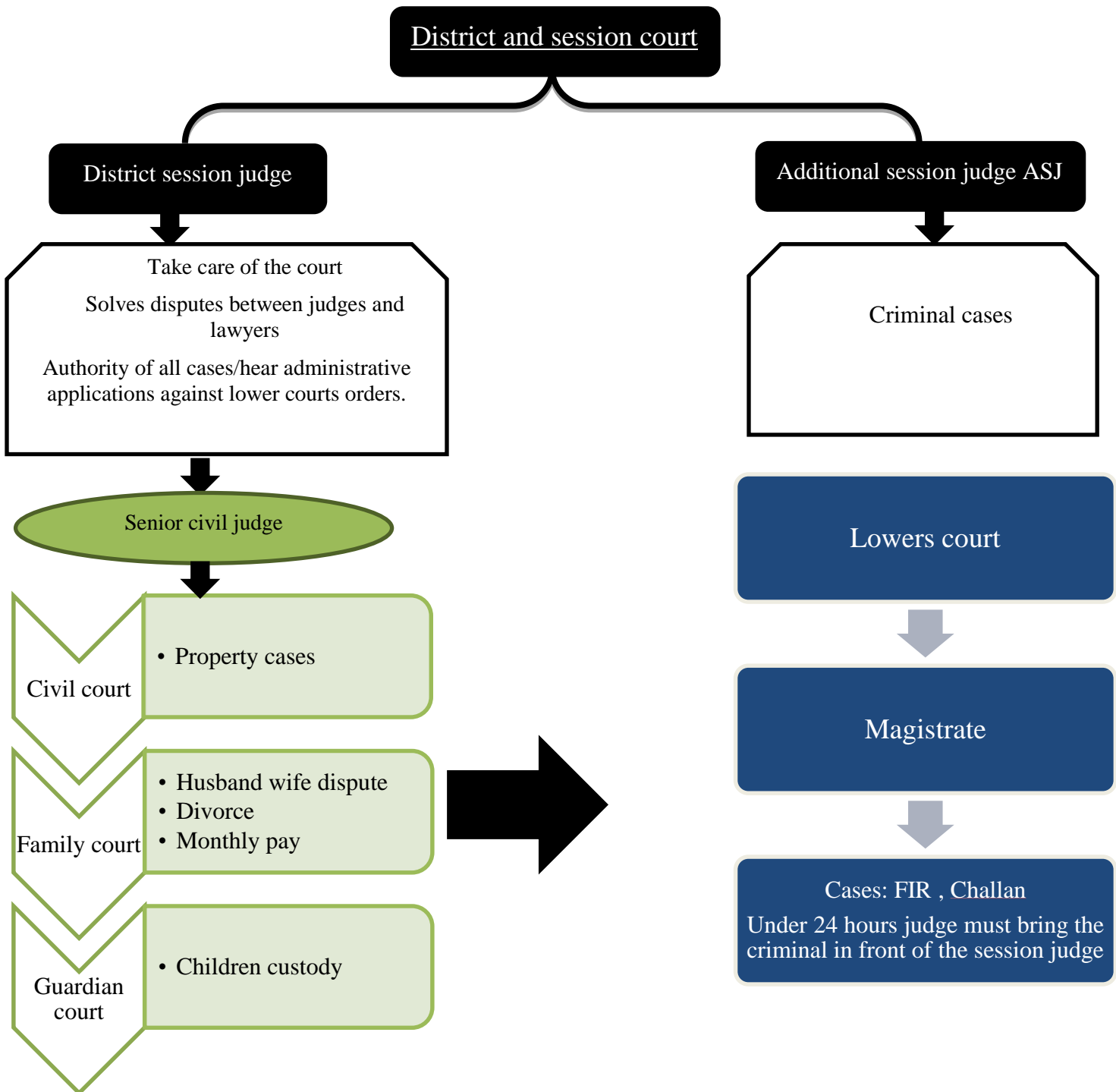


**Figure 3: District & Session Courts of Pakistan**

## 2.6 HIERARCHY OF COURTS



## 2.7 HIERARCHY OF DISTRICT AND SESSION COURT JUDGES



## 2.8 STRENGTH OF JUDGES

### Subordinate Courts

Court	Punjab	Sindh	Balochistan	KPk	ICT
District & Sessions Judge	37 (+ 84 ex-cadre)	27	30	25	2
Addl. District & Sessions Judge	607	115	32	103	30
Senior Civil Judge & Civil Judges-cum-Judicial Magistrates	1722	362	204  (Member Majis-e-Shura) 16  (Qazi) 30	322	56
<b>Total</b>	<b>2450</b>	<b>504</b>	<b>312</b>	<b>450</b>	<b>88</b>

**Table 1: Subordinate Courts**

## 2.9 STUDY OF PERSONALS AND SPACES

### 2.9.1 District And Session Judge:

Every district has one district and session judge. It is the highest official rank in the lower courts. When he handles criminal cases, he is called a session judge, for example murder, rape etc. when he handles civil cases, he is called district judge. He hears appeals against the decision of civil judges. He has got the powers to give the death or life with the approval of high court. He also handles all the administrative work.

### 2.9.2 Additional Session Judge

He has the same powers as the session judge. A session judge is a senior person with administrative powers.

### 2.9.3 Magistrate

Magistrate with the power handles the criminal cases. He is immediately below the A.S.J and is superior to the 1<sup>st</sup> class magistrate. He can give a sentence up to 7 year's imprisonment.

### 2.9.4 Civil judge

He handles the cases of civil nature like property, family problems like divorce etc.

### **2.9.5 Court room**

It is a hall with an honorable judge, reader, steno, lawyers sitting space, public sitting space and a security guard.

### **2.9.6 Ahlmad**

He calls the person and presents the case. He is the record keeper of the court. “AHL” means capable and “MAD” means record. Anybody can approach him. He sits in a room adjacent to court room.

### **2.9.7 Reader**

He presents the case to the judge or call case. He sits with the judge on the rostrum.

### **2.9.8 Nazir**

He keeps the accounts. He has all the pay record. He is also called Munshi.

### **2.9.9 Steno**

He is a typist in courtroom. He types all the hearing of case in courtroom. Two stenos in courtroom, one for English and other for Urdu dictation.

### **2.9.10 Bakhshi khana**

It is a place where they keep the accused persons. All the prisons are kept in bakhshi khana until the time of hearing.

### **2.9.11 Administration branch**

This branch takes care of all the administrative work, i.e., all the hiring and firing of employees of lower grades like clerks, peons, gardens and sweepers, etc. this branch takes care of the pays and also keeps the record of the leave and vacation of the workers. This branch also deals with the budget and accounts of the courts.

### **2.9.12 Naib court**

He is responsible for the custody of police files in criminal court.

### **2.9.13 Judicial record room**

All applications of decided files regarding criminal and civil, etc., are kept in the judicial record room. Record keeper provides case to the copying branch to make a copy for the person who needs it.

### **2.9.14 Copying branch**

Applications are accepted on prescribed forms on payment of the fee for getting copies of civil record and criminal cases. Copies of the decided cases can be taken by anybody whereas the concerned parties can only take copies of the undecided cases.

### **2.9.15 Stationary branch**

This branch provides stationary, file covers, registers and common warrants. They buy these from Govt. printing press.

### **2.9.16 Lock up**

Two lockups, one each for male and for female prisoners is provided. After the hearing if the judge announces the sentence, prisoners are locked in the lockups instead of the bakhshi khana. If a prisoner is brought from a far-off place for the court hearing, he or she is kept in the lockup.

### **2.9.17 Lawyer's chambers**

It consists of two rooms usually, one for the lawyer where he meets the litigant and parties. Here he meets with the parties and prepares for the cases. Other room is for his munshi and it serves as a waiting area for the litigants. In these offices there should be ample space for bookracks and a cupboard for lawyer's personal belonging.

### **2.9.18 Canteen**

Public or also the lawyers use it.

### **2.9.19 First aid**

First aid room or a dispensary is provided for lawyers and an M.B.B.S. Doctor should always be available.

### **2.9.20 Bar room**

It consists of a canteen, library, toilet and anteroom.

### **2.9.21 Anti-room**

Its lounge, a meeting place for lawyers. It also serves as a function hall or place for conference. It is preferable that separate rooms for ladies and gents are provided.

### **2.9.22 Library**

Library is the most important and necessary part of the court or bar room. It should have private noise free atmosphere. Books can't be borrowed, lawyers can only consult them while sitting there.

### 3. SITE ANALYSIS

---

#### 3.1 NANKANA SAHIB CITY

Nankana Sahib is a city and capital of Nankana Sahib District in the Punjab province of Pakistan. It is named after the first guru of the Sikhs, Guru Nanak. Guru Nanak spread the light of the universal message to this world so it is a city of high historic and religious value and is a popular site for Sikhs from all over the world. It is located about 80 kilometers south west of Lahore and about 75 kilometers east of Faisalabad. The area around Nankana Sahib was formerly a tehsil of Sheikhpura District. In May 2005, the provincial government decided to raise the status of Nankana Sahib to that of a district as a way of promoting development in the area. The development of Nankana Sahib, the birthplace of Guru Nanak in Pakistan is one of the numerous projects by Punjab Government. The work of development of Nankana Sahib shifting of district and session court to near big place. City has a population of approximately 150,000.

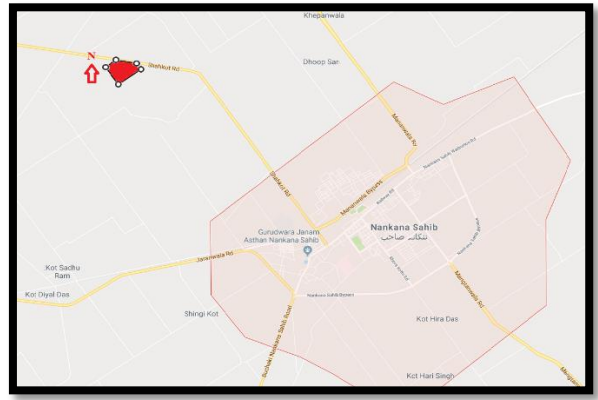
#### 3.2 SITE LOCATION

The site is located in Capital of Nankana Sahib District in the Punjab province of Pakistan.

DMO Nankana Sahib allocated the place for this on direct orders of District Coordination Officer and GOP. Which stated now 3.1 km far from Nankana on Shahkot road side by Shah Filling Station. The site is connected to the main road.

Total bought area is 28 Acers.

The site for construction is under initial analysis (Soil and material check).



**Figure 4: Site Location**

### 3.3 SURROUNDINGS

- Neighborhood of the site is basically an unconstructed area.
- On the east side, there is a PSO shell and kachi abadi on some distance.
- On north side is main road and cultivated land.
- On south lies, some houses and Deras.
- On north side, there is also cultivated land.



**Figure 5: Surroundings**

### **3.4 LAND ANALYSIS**

The Following physical feature characterize the land.

- Agricultural land.
- Smooth land having no contours.
- The site is -2 ft. in depth to the main road

### **3.5 INFRA STRUCTURE**

All infra-structure like water, electricity and gas are establishment of DISTRICT COURT. Sewerage and disposal plant for the site will be developing. The site will also have a substation in latest stage.

### **3.6 CLIMATE**

The climate remains excellent during spring and autumn; however, it remains relatively hot and cold during summer and winter respectively.

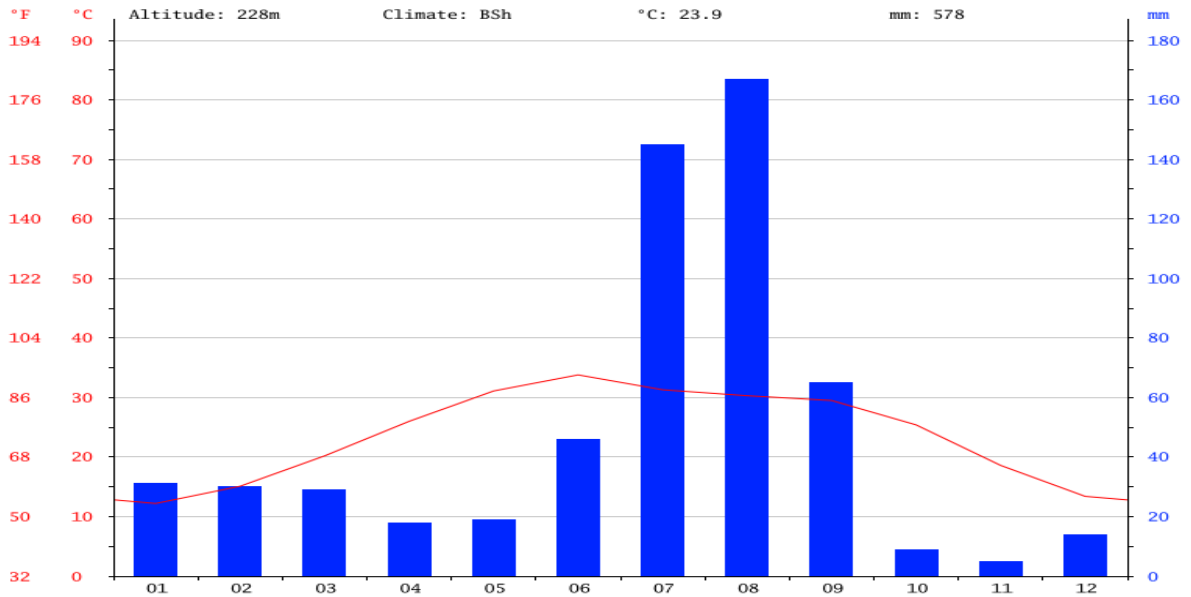
Seasons	Winter (Oct-March)	Summer(April-Sep)
Max average	17 C	35-42 C
Min average	4 C	0-20 C

**Table 2: Climate**

Nankana Sahib has a [hot semi-arid climate](#) according to the [Köppen-Geiger system](#), and changes throughout the year. During summer (June to September), the temperature reaches 36–42 °C (97–108 °F). The coldest months are usually November to February, when the temperature can drop to an average of 7 °C (45 °F). The highest-precipitation months are usually July and August, when the [monsoon](#) reaches the Punjab. During the other months, the average rainfall is about 25 millimeters (0.98 in). The driest months are usually November to April, with little rainfall.

LATITUDE 32 9' 32" N

LOGTITUDE 74 10' 48" E



**Figure 6: Climate**

### 3.7 REASON FOR THE SITE SELECTION/FEASIBILITY

The reason why I have select particular site are,

- There is not enough space inside the city where such as large district and session court and residency can be built.
- The site easily accessible inside or outside the city.
- It is 3.1 km far from Nankana on Shahkot road side by Shah Filling Station.
- The site is 5m car and 20 to 25 min walking distance of the existing district court.
- The site area is 28 acres so the requirements of the project will be completed on the site.
- The site for construction is under initial analysis (Soil and material check).

#### 3.7.1 SITE PICTURES



**Figure 7: Site Pictures**

## **4. CASE STUDIES**

---

### **4.1 NATIONAL CASE STUDIES**

#### **4.1.1 INTRODUCTION**

Lahore being capital city of Province of Punjab of Pakistan is located in north eastern end of Punjab having border with Indian State of Punjab. It is ranked as a beta-world city and is one of Pakistan's wealthiest cities.

Lahore is also having historic cultural center in the world. The city has a long history and was once under rule of Hindu, Shahi's, Ghaznavids, Ghurids and the Delhi Sultanate. It reached height of its splendor under Mughal Empire, serving as its capital city for a number of years. The city was captured by the forces of Persian Afsharid Emperor Nader Shah during his invasion of the Mughal Empire. The city was then contested between different powers before it became capital of the Sikh Empire and then the capital of the Punjab under British rule.

Similarly, Lahore was central point to independence movements of both India and Pakistan, with the city being site of both declaration of Indian Independence, and resolution calling for establishment of Pakistan. Following independence of Pakistan in 1947, Lahore became capital of Punjab.

Lahore is one of Pakistan's modern cities. The city is also a major center of education in country, with some leading universities. The city also hosts much of Pakistan's tourist industry, with major attractions including the old Walled City, numerous Sikh Shrines and the Badshahi and Wazir Khan Mosques. Lahore is also home to the UNESCO World Heritage Sites of Lahore Fort and Shalimar Gardens. The people of city are very jovial hospitable. The political influence and contest but this city develops no other city has any boost. The main offices of different departments are hosting premises there such as Lahore High Court, Lahore, GPO, Civil Secretariat, Punjab Assembly, Lahore Railway Station and Governor House etc. It is also city of parks and cinema halls. It is also famous for its food streets.

## 4.1.2 LOCATION

District and session court Lahore on Rajgarh road near Punjab civil secretariat, Pakistan.

## 4.1.3 TYPE

District and Session court

## 4.1.4 AREA

22 kanal

## 4.1.5 FLOORS

3 story court building

## 4.1.6 TIMMINGS

8-3summer, 9-4 winter

## 4.1.7 GATES

Total 3 gates of the court

## 4.1.8 LOCATION MAPS

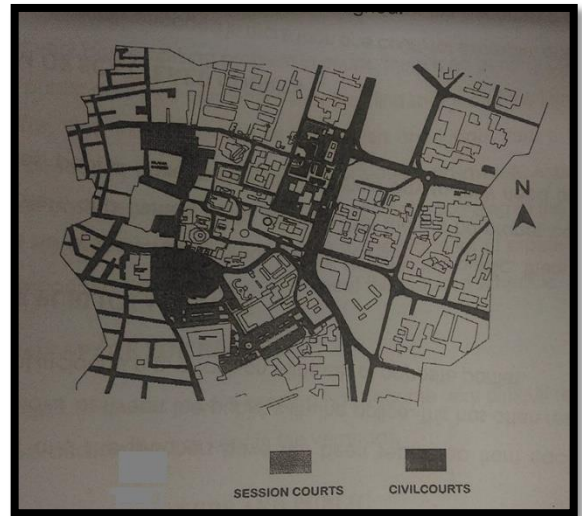
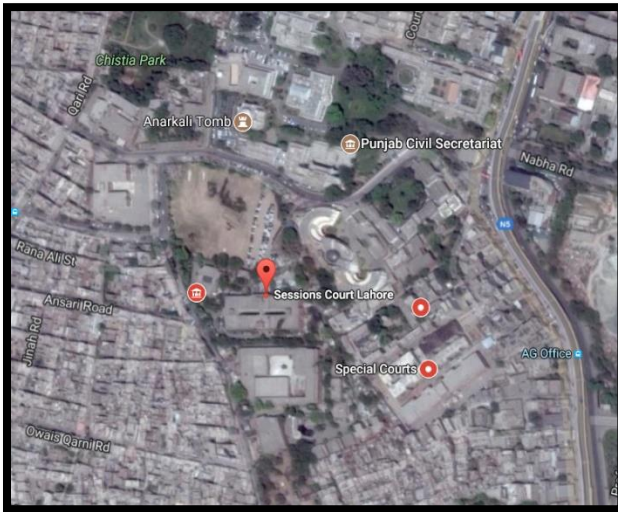


Figure 8: Location Maps

## 4.1.9 FLOOR PLAN



**Figure 9: Floor Plan**

## 4.1.10 BUILDINGS

- Head of the Session court building
- Additional judge of the court building
- Case file building
- Court rooms building

- Lockups building
- Dispensary/hospital building
- Lawyers chamber building

#### **4.1.11 FACILITIES**

- Conference room
- Lawyers chambers
- Case file building
- Head of the court building
- Printing and stationary shops
- Post office
- Cafeteria
- Bank
- Mosque
- Library
- Dispensary
- Lockups
- Bakhshi khana
- Parking
- Elevators

#### **4.1.12 DESCRIPTION**

- 30 to 40 court rooms in a building
- 10 rooms and 5 halls in one row
- 1 judge is in one room
- 1 judge should have 10-15 cases in a day.

#### **4.1.13 STRUCTURE OF COURT ROOM**

**Court room:** Judge, Reader, Steno, Lawyers sitting space,  
Public sitting space, security guard.

**Rooms attach court room:** Judge Room, record room

**Area of the room:** 25' x 15'

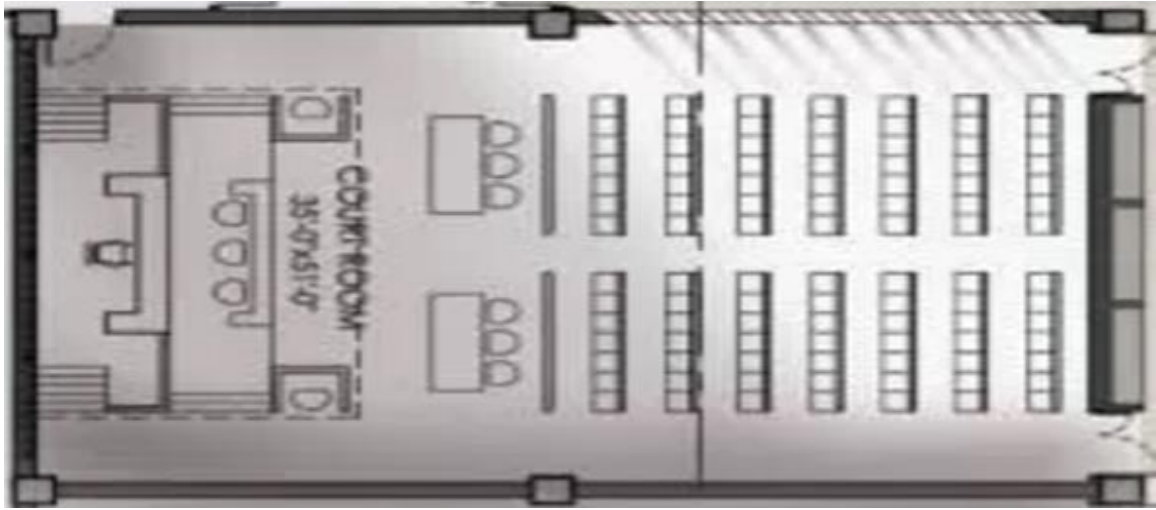
**Witness box:** 3'

**Judge sitting space:** 14" above

**Judge chamber:** 5' x 8' room

**Celling height:** 12'

**Public sitting space:** 10 persons



**Figure 10: Court Room Structure**

#### **4.1.14 LAWYERS SITTING SPACE**

- There are no chambers for layers
- They sit outside of the building in open space
- They face problems especially in winters.

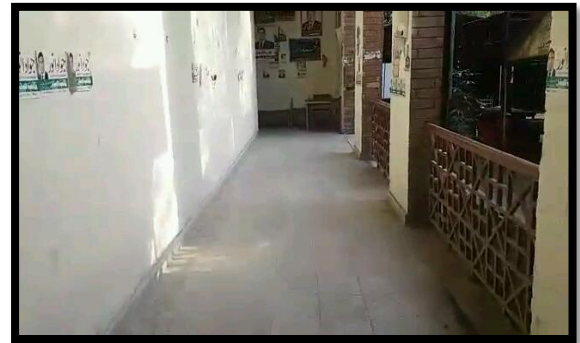
- Lawyers sitting space are on the path of the court.



**Figure 11: Lawyers Sitting Space**

#### **4.1.15 CORRIDORS**

- 7 to 8ft along with the court rooms.
- Natural light comes through the corridor.
- It circulates around the whole building.
- The railing use side of the corridor to create partition/separation.
- The windows take natural light through the corridors.



**Figure 12: Corridors**

#### 4.1.16 PUBLIC WAITING AREA

- Outside hall of court room
- Sitting space for public in waiting of their turn of cases
- 30' to 40' space for hall of entrance of two Court rooms,
- Public Washroom, Ahlmed record room.
- Entrance door of court room
- Ahlmed record room attach with court room
- 1 or 2 months record is there.
- 4 to 5 persons sit there.



Figure 13: Public Waiting Area

#### 4.1.17 CHAMBERS FOR LAWYERS

- 300 chambers for lawyers
- 5 to 6 lawyers use 1 room

- 10' x 10' space of one room



**Figure 14: Chambers of Lawyers**

#### **4.1.18 BAR HALL FOR LAWYERS**

- 50 to 60 lawyer's capacities
- Kitchen and ladies separate bar
- It is use for as a meeting hall or as a separate cafeteria for lawyers.



**Figure 15: Bar Hall for Lawyers**



**Figure 17: ATM Machine**



**Figure 16: Hospital**

#### **4.1.19 JUDGES CAR PARKING**

- 30 to 35 car separate parking for judges.
- Parking is near to the court rooms where the judges can easily access.
- Separate entrance use for car parking of the judges.



**Figure 18: Judges Car Parking**

#### **4.1.20 LIBRARY, COMPUTER LAB AND NEWSPAPER AREA**

- 10,000 books capacity in library
- It has a separate hall where the lawyers read the law books.
- Library has 50 to 60 person's capacities.
- Computer lab attach with library.
- The reading of newspaper area also there and it is separate with the partition wall.

- Computer lab is for 20 persons.
- Reading newspaper area if for 10 to 15 persons.



**Figure 19: Library, Computer Lab & Newspaper Area**

#### **4.1.21 MOSQUE**

- The mosque is in civil court 100 people pray jumah at a time.
- There is no mosque in session or district court. Or not the prayer room for public.
- The shades are use in the hall of the outside of the mosque where the lawyers or public pray Jumah together.



**Figure 20: Mosque**

#### **4.1.22 Building Material**

- The major buildings structure is frame structure of bricks and concrete.
- Bricks have been used on the buildings and the columns are of concrete with brick exterior finish.
- Mostly the tile is use on floor finishing of some buildings.

#### **4.1.23 Architecture**

District court was constructed in the British period, so the architecture of some building in district court is British architecture. Some buildings were constructed later with the needs, the architecture of those buildings is modern.

Session court was constructed in 2012. The architecture is modern architecture.

Civil court/ Awan e Adal was constructed in 1994. It is planned as ground plus three structures. Geometric patterns use in concrete made jalies and combination of plastered and brick finish.

#### **4.1.24 CONCLUSION**

##### **MERITS:**

- The building is good designed as the max. natural light incorporate.
- Proper security system is provide.
- Elevators provide in building.
- Parking for judges is good with a separate entrance.

##### **Demerits:**

- No proper space for public siting or waiting area.

- No proper space for lawyers , poor condition of chambers, No proper parking for lawyers.
- Food stalls place where they want, no space for stationary shops.
- No separate paths for judges, they walk through the public paths.
- The main issue, there is no proper record room. The files are lay down on the floor and pack in the cloth. Lack of space for record.
- No green areas are provided where the people sit or wait. As people wait for the long time in court.
- Conjusted and narrow paths for walking to go to the buildings.
- No conferece hall for judges.
- There is no prayer room for public or lawyers in session and district court.

## **4.2 INTERNATIONAL CASESTUDY**

### **4.2.1 INTRODUCTION**

New Orleans is a Louisiana city on the Mississippi River, near the Gulf of Mexico. Nicknamed the "Big Easy," it's known for its round-the-clock nightlife, vibrant live-music scene and spicy, singular cuisine reflecting its history as a melting pot of French, African and American cultures. Embodying its festive spirit is Mardi gras, the late-winter carnival famed for raucous costumed parades and street parties.

- **Population:**

- 391,495 (2016)

- **Mayor:**

- Mitch Landrieu

- **Parish:**

- Orleans Parish

## 4.2.2 PROJECT DISCRIPTION

**Location:** 421 Loyola Ave #402, New Orleans, LA 70112, USA

**Type:** Civil District court building

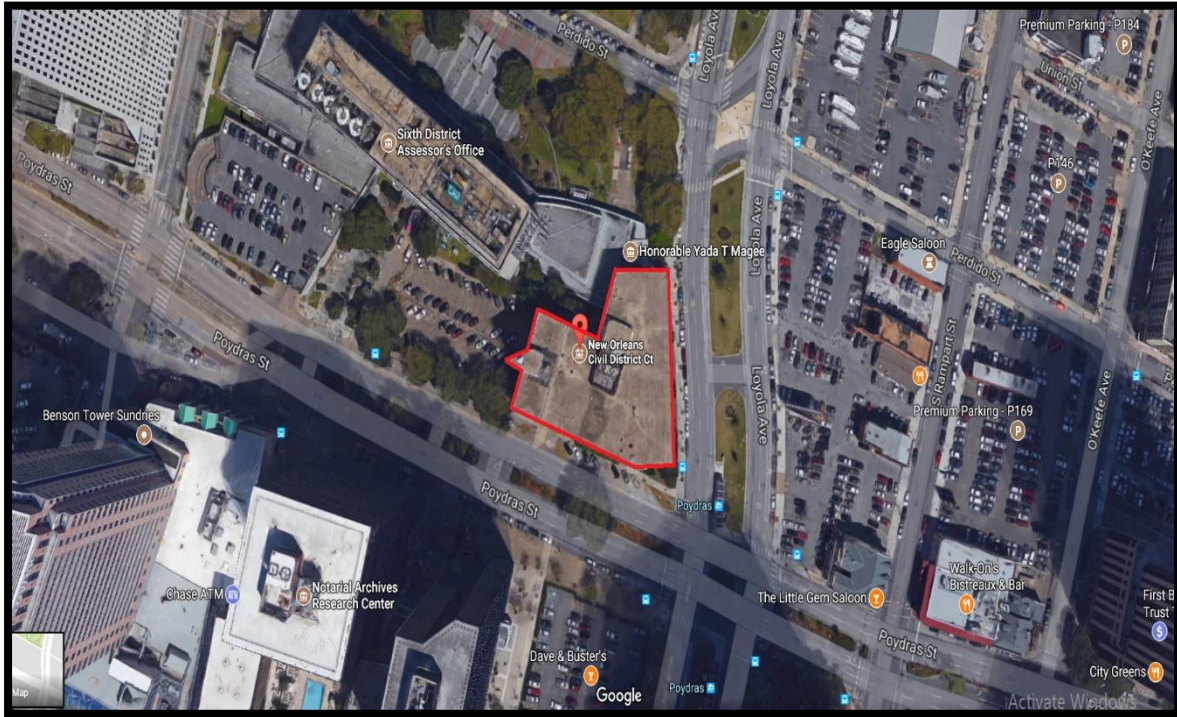
**Architect:** Yeates and Yeates Architects, LLC

**Floors:** 4 story building













**Figure 21: Project Description**

### 4.2.3 MASTER PLAN



**Figure 22: Master Plan**

### 4.2.4 STUDY OF PERSONAL AND SPACES

SPACE DESCRIPTION	1ST LEVEL	2ND LEVEL	3RD LEVEL	4TH LEVEL	LEVELS 1 - 4
 PUBLIC AREAS AND LOBBIES	5,400 SF	3,900 SF	5,000 SF	4,200 SF	18,500 SF
 BUILDING SUPPORT	900 SF	500 SF	600 SF	1,500 SF	3,500 SF
 CIVIL DISTRICT COURT	-	5,300 SF	21,400	9,600 SF	36,300 SF
 FIRST CITY COURT	-	9,800 SF	-	-	9,800 SF
FCC COURTROOMS AND CHAMBERS	-	(6,300 SF)	-	-	(6,300 SF)
FCC CLERK (OFF-SITE STORAGE NOT INCLUDED)	-	(3,500 SF)	-	-	(3,500 SF)
 SHARED JUDICIAL	-	-	-	900 SF	900 SF
 SHERIFF	200	-	500 SF	4,800 SF	5,500 SF
 CONSTABLE	-	2,000 SF	-	-	2,000 SF
 JUDICIAL ADMIN. - JEF	-	-	4,000 SF	-	4,000 SF
 CDC CLERK (AREA DOES NOT INCLUDE 1340 POYDRAS LOCATION OR OFF-SITE STORAGE LOCATIONS)	-	-	-	10,500 SF	10,500 SF
 JUVENILE COURT	16,000 SF	10,000 SF	-	-	26,000 SF
<b>GROSS BUILDING AREA (APPROX):</b>	<b>22,500 SF</b>	<b>31,500 SF</b>	<b>31,500 SF</b>	<b>31,500 SF</b>	<b>117,000 SF</b>

**Figure 23: Study of Personal Space**

## 4.2.5 FLOOR PLANS

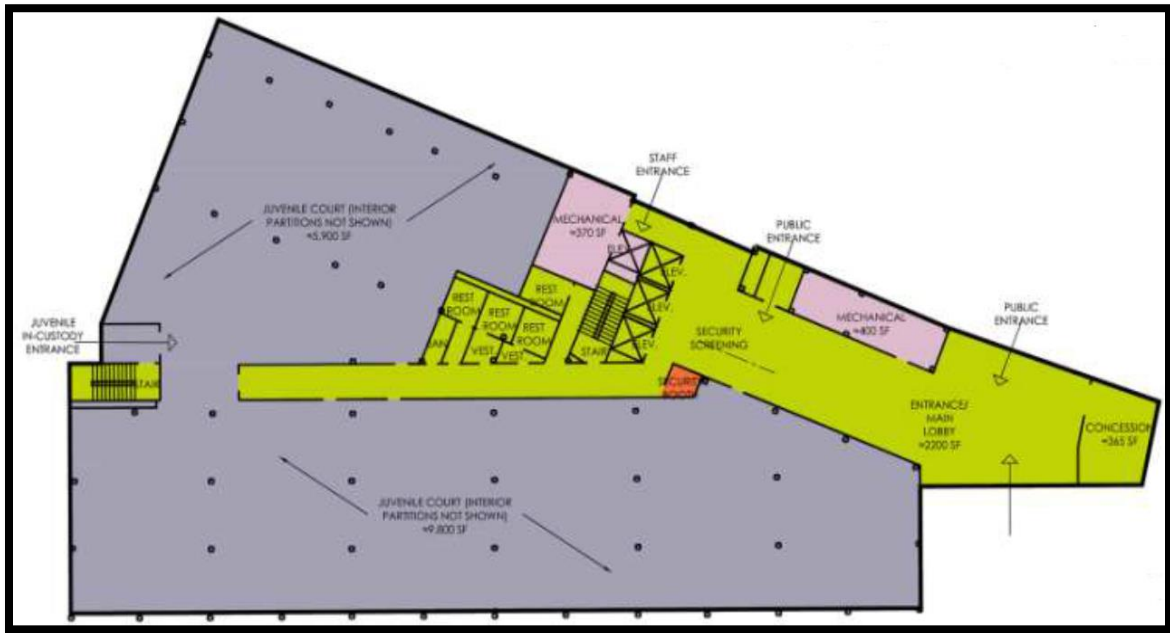


Figure 24: Floor Plans



# DETAIL OF FLOORS

Total Interior Footprint Depth and Width: 141' x 142' (20,022 SF)  
**3<sup>rd</sup> Floor – Archived Records:**


- 1. 3<sup>rd</sup> floor - Flat Files Room**
  - Includes oversized Land Records incl. maps and plans
  - Overall room dimensions: 36' x 24'6" (822 SF)
  - Individual Unit Dimensions: 5'6" wide x 4'2" deep x 1'4" tall – Stacked 3 high



- 4. 3<sup>rd</sup> Floor – Open Shelf Archived Record Shelving**
  - Adjacent to previous high density storage area
  - Includes archived land record books
  - Overall room dimensions: 42' x 25' (1,050 SF)
  - Individual Unit Dimensions: 7' high x 3' wide x 32" deep (double sided)



- 2. 3<sup>rd</sup> Floor - High Density Storage Area One**
  - Includes archived land record books
  - Units are protected from water penetration
  - Overall room dimensions: 34' x 33'7" - Includes 5' access aisle one end (1,139 SF)
  - Individual Unit Dimensions: 7'2" high x 3' wide x 24" deep (double sided)
  - Counted 14.5. rows (14 @ 24" deep and one end unit @ 12" deep)




- 7. 3<sup>rd</sup> Floor – Other Shared Spaces**
  - Break Room
  - Public reception/ waiting 12' x 12' (144 SF)
  - Public Reading Rooms (2 on third floor)
  - Open work area next to reception desk



**4<sup>th</sup> Floor – Mortgage and Conveyances:**  
 (Note: Suite 400 Admin Offices not measured)

- 1. 4<sup>th</sup> Floor – Mortgage Book Shelving**
  - Includes double sided table height shelving
  - Overall room dimensions: 34'9" x 40' (1,390 SF)
  - (4) Individual Table Ht Units: 25' x 3' x 42" tall
  - (15) Open Shelving Units (7'x3'x15")



- 2. 4<sup>th</sup> Floor – Card File Storage**
  - Overall room dimensions: 23' x 29' (667 SF)
  - Include 2 Work Tables



**6. 4<sup>th</sup> Floor – Mortgage and Conveyances Public Waiting**

- a. 32 seats counted – tightly arranged (Chelsea says this number of seats is adequate current amount)
- b. Overall room dimensions: 30' x 15' (450 SF)



**4<sup>th</sup> Floor – Conveyances - Open shelving and work table area**

- a. Includes double sided open shelving and work tables against wall
- b. Overall area dimensions: 24' x 20' (480 SF)
- c. (20) Open Shelving Units (7'x3'x15")

**5<sup>th</sup> Floor – Notarial Archives Open Shelving Area Two**

- a. Located Between Open Shelving Areas One and Two
- b. Area dimensions: 104' x 42' (4,368 SF)
- c. (296) Open Shelving Units (7'x3'x15") – 5 Shelves each unit

**5. 5<sup>th</sup> Floor – Notarial Archives Open Shelving Area Three**

- a. Adjacent to Open Shelving Area Two
- b. Area dimensions: 38' x 69'6" (2,641 SF)
- c. (144) Open Shelving Units (7'x3'x15") – 5 Shelves each unit
- d. Space includes approx 250 SF work and copy area

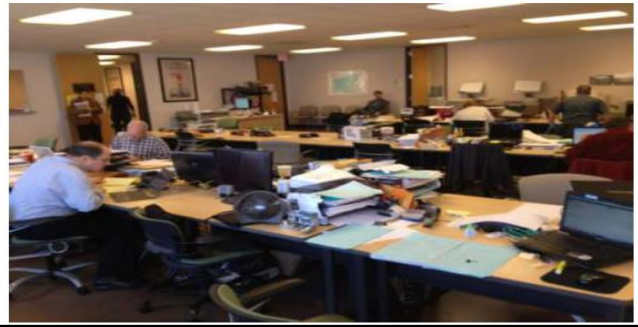


**5<sup>th</sup> Floor –Notarial Archives:**

1. 5<sup>th</sup> Floor – Notarial Archives Public Waiting Area
  - a. 8 Seats
  - b. Room dimensions: 15'x20' (300 SF)



2. 5<sup>th</sup> Floor – Notarial Archives Public Research Area
  - a. Used primarily by title company abstractors
  - b. (46) 2'x4' work tables
  - c. (11) Reading Carrels
  - d. (2) staff help desks (w/ 4 public chairs each)
  - e. (8) copy machines
  - f. (1) 30" x 48" High Top Work Table

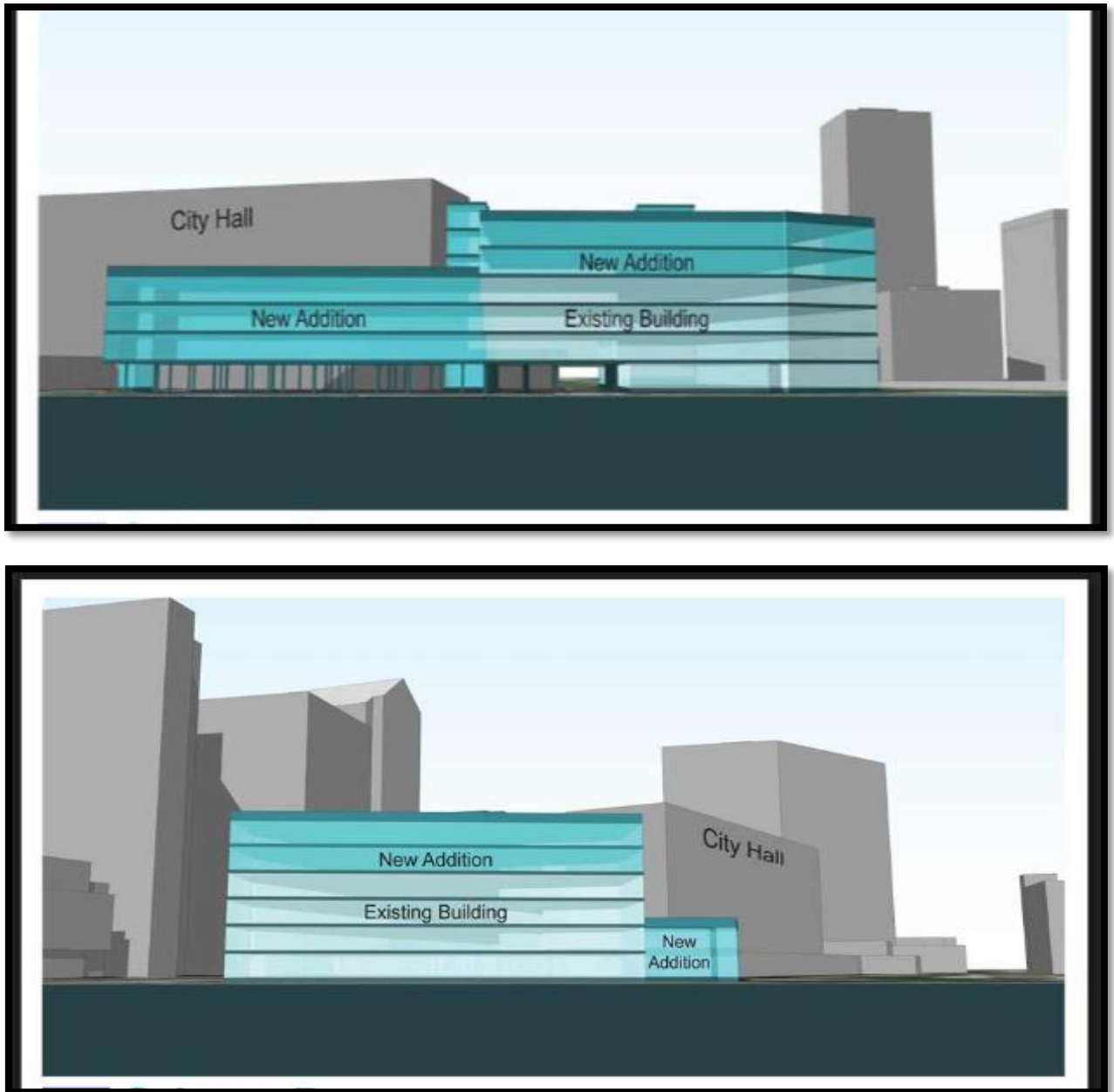


3. 5<sup>th</sup> Floor – Notarial Archives Open Shelving Area One
  - a. Adjacent to public research area
  - b. Area dimensions: 90' x 36' (3,240 SF)
  - c. (224) Open Shelving Units (7'x3'x15") – 5 Shelves each unit



**Figure 26: Floors Details**

#### 4.2.7 ELEVATIONS/3D VIEWS



**Figure 27: Elevation 3D View**

#### 4.2.8 3D VIWES



Figure 28: 3D View

## 4.2.9 CONCLUSION

### **MERITS:**

- Proper record rooms provided, Files are kept in cupboards in their sections given by their names.
- Proper waiting area provided for public.
- Proper court rooms attach with judge's chambers and kitchen.
- Proper Computer lab provided.
- All the things provided under one roof.

### **DEMERITS:**

- No green spaces are provided.
- No proper parking provided but still working on it.
- No proper connection with natural light.
- The height of the floor is 10' instead of 12' to 16' which appear congested space.

## 5. REQUIREMENTS

---

### 5.1 REQUIREMENTS

- Head of the Session court building
- Criminal court
- Civil court
- Case file building
- Lockups building
- Dispensary/hospital building
- Lawyer's chamber building
- Stationary/copy/printing building
- Bank
- Mosque
- Library
- Cafeteria/ bar hall

### 5.2 ANOTHER REQUIREMENTS

- Some requirements of district courts are as follow:
- Courts are approx. 60 to 70 judges, with retiring room and attach bath.
- Space for Alhmad and steno with each court room.
- Offices for district attorney and deputy district attorney.
- Meeting and conference hall for lawyer's.
- Meeting and conference hall for judges.
- Library for judges for more than 10,000 books.
- Library for lawyers for more than 10,000 books.

- Space for general record, civil record for more than 150,000 files each.
- Chambers for lawyers for approx. 300 lawyers.
- Offices for superintendent and clerks of courts.
- Parking for 100 to 150 cars for public and lawyers.
- Parking for 70 to 80 cars for judges.
- Waiting spaces common public.

### 5.3 CALCULATIONS

#### JUDICIAL COURT COMPLEX

<u>Sr. No</u>	Description	Q.T Y	Standards (Sq. Ft)	Total (Sq. Ft)
1	SENIOR CIVIL JUDGE COURT	1	800	800
2	Civil judge court room	59	700	41300
3	Retiring room	60	200	12000
4	Steno room	60	120	7200
5	Alhmed	60	100	6000
7	Clerk record	1	850	850
8	Copy branch	1	850	850
9	Assistant superintendent	1	150	150
10	Computer branch	1	200	200
11	Litigants sitting area	60	250	15000
	Total			84350
	Circulation		30%	25305
	Grand total			109655

**Table 3: Judicial Court Complex**

## BAR ASSOCIATION AND LAWYERS CHAMBER

<u>Sr. No</u>	Description	Q. Ty	Standards (Sq. Ft)	Total (Sq. Ft)
1	Lawyers Chamber	300	150	45000
2	Bar room	2	1600	3200
3	Meeting hall	2	8000	16000
4	Library	1	3500	3500
5	Librarian	1	120	120
7	Photostat	3	100	300
	Total			68120
	Circulation		30%	20436
	Grand total			88556

**Table 4: Bar Association & Lawyers Chamber**

## JUDGES RECEREATIONAL FACILITIES

<u>Sr. No</u>	Description	Q. Ty	Standards (Sq. Ft)	Total (Sq. Ft)
1	Library	1	2500	2500
2	Librarian	1	120	120
3	Conference room	2	1000	2000
4	Lounge	3	400	1200
5	Kitchen and store	1	400	400
6	Photostat	2	80	160
	Total			6380
	Circulation		30%	1914
	Grand total			8294

**Table 5: Judges Recreational Facilities**

## JUDICIAL LOCKUPS

<u>Sr. No</u>	Description	Q. Ty	Standards (Sq. Ft)	Total (Sq. Ft)
1	Officer waiting	1	250	250
2	Constable sitting	1	1000	1000
3	Male lockup	1	1800	1800
4	Female lockup	1	300	300
5	Prisoner van	5	200	1100
	Total			4450
	Circulation		30%	1335
	Grand total			5785

**Table 6: Judicial Lockup's**

## ALLIED FACILITIES

<u>Sr. No</u>	Description	Q. Ty	Standards (Sq. Ft)	Total (Sq. Ft)
1	Cafeteria	1	15000	15000
2	Waiting area	3	2200	6600
3	Public washroom	30	20	600
4	Record room	3	2000	6000
5	Mosque	1	1500	1500
6	Stamp paper & printing	8	70	560
	Total			30260
	Circulation		30%	9078
	Grand total			39338

**Table 7: Allied Facilities 1**

## ALLIED FACILITIES

<u>Sr. No</u>	Description	Q. Ty	Standards (Sq. Ft)	Total (Sq. Ft)
1	Cafeteria	1	15000	15000
2	Waiting area	3	2200	6600
3	Public washroom	30	20	600
4	Record room	3	2000	6000
5	Mosque	1	1500	1500
6	Stamp paper & printing	8	70	560
	Total			30260
	Circulation		30%	9078
	Grand total			39338

**Table 8: Allied Facilities 2**

## 6. BIBLIOGRAPHY

---

### 6.1 Books

De Architectura

Book by Vitruvius

101 Things I Learned in Architecture School

Book by Matthew Frederick

The Architecture of Happiness

Book by Alain de Botton

Cabin Porn: Inspiration for Your Quiet Place Somewhere

Book by Steven Leckart and Zach Klein

Modern architecture since 1900

Book by William J. R. Curtis

### 6.2 Journals

<https://www.architectsjournal.co.uk/>

<https://www.tandfonline.com/toc/rjar20/current>

<https://www.tandfonline.com/loi/rjar20>

<https://www.scimagojr.com/journalrank.php?category=2216>

<https://www.archdaily.com/tag/the-architects-journal>

<http://www.architectmagazine.com/>

### 6.3 Articles

<https://www.architecturaldigest.com/topic/architecture>

<https://placesjournal.org/explore-places/architecture/>

<https://www.nytimes.com/topic/subject/architecture>

### 6.4 Research papers

<https://www.questia.com/library/art-and-architecture/architecture>

<http://faculty.fiu.edu/~readg/TipsLinks/HowtoWriteaResearchPaper.htm>

<http://guides.lib.umich.edu/c.php?g=282912&p=1885208>

<https://ajar.arena-architecture.eu/>

### 6.5 Other References

<https://www.youtube.com/watch?v=BLzVNjED2yg>

<https://www.youtube.com/watch?v=iDtOrjLYU3o>